

Sprinter Campfire - Sprinter Campfire 32FWBH

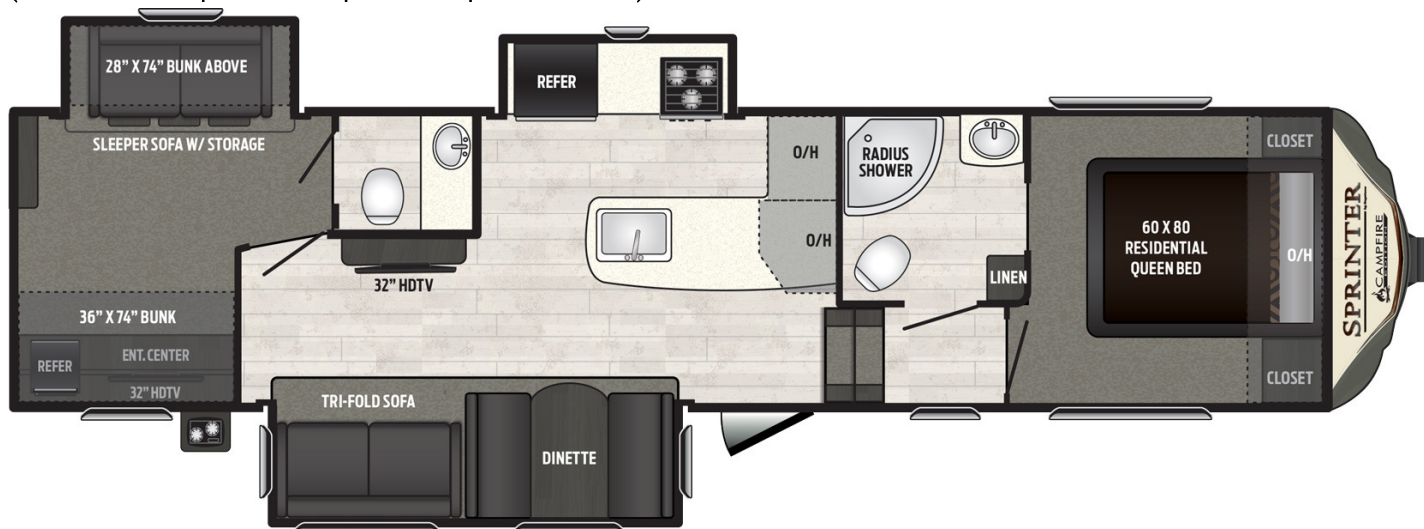

(/fifth-wheels/sprinter-campfire/floorplans/29fwr1/)



KEY SPECIFICATIONS - 32FWBH

- Shipping Weight
- Carrying Capacity
- Hitch
- Length
- Height
- Fresh Water
- Waste Water
- Gray Water
- LPG
- Tire-Size
- Sleeping Capacity
- Region

CAMPFIRE FIFTH WHEEL EXTERIOR FEATURES

- Keyed Alike lock system
- Furrion solar prep quick connect
- Furrion back up camera prep
- Industry best, 100" Wide body construction
- 100" wide-stance axles
- Control TT auto leveling jacks
- 30" friction hinge entry door
- Electric awning with Auto-Dump, friction-hinge adjustment, LED light strip, manual override, and speakers
- Backed for rear ladder
- 2 Battery tray
- Splash guard under slide
- G4 cable slide system w/ 4 point seal
- Best in class 2" laminated aluminum framed sidewalls
- Enclosed underbelly with direct vent heat
- E-Z Lube axles

Stock Only

Most Popular

New

Bunkhouse

Interior Kitchen

Outdoor Kitchen

Front Living Area

RV Type

Brands

- Tinted safety glass windows
- Road Armor suspension
- Rear bumper storage w/ end caps
- Aluminum triple entry step
- XL entry door grab handle
- Tough Guard painted skirt metal
- 4" extra long rain spouts
- Two 30lb. LP bottles with auto change-over regulator
- Blow molded seamless holding tanks
- Black tank flush system
- Spray Port
- 50 Amp power cord (Except 26FWRL-30 AM Standard)
- Cable and satellite hook-up
- Aluminum wheels
- Spare tire
- Outside TV cable hookup with 110 recep in pass thru
- Outside kitchen models include: two burner cook-top, 32" LED TV, 1.7 cu. ft. 110v fridge & storage
- Remote control system (Slideouts, Auto Level System & LED light strip, Awning)

CAMPFIRE FIFTH WHEELS INTERIOR FEATURES

- Full 96" interior width (Added square footage)
- 5/8" water resistant Dynaspan flooring with 25 year full, and limited lifetime warranty
- 80" Interior Height
- 12 Volt, 55 amp converter
- 35,000 BTU auto-ignition furnace
- 15,000 BTU ducted air conditioner with "Quick Cool"
- Windows in both Slide-room end walls
- Water heater bypass for easy winterization
- Digital Thermostat
- Residential cabinet hardware
- Large picture window at the dinette & sofa
- Interior access, manual override for the slide rooms
- In-floor hard-ducted heat
- LED overhead lighting in every room
- Central Command Center for monitoring all tanks and battery, awning, slide-outs, lights, etc.
- Screwed cabinetry with lumber-core stiles
- Beauflor Linoleum w/ 7 year warranty (2 year cold crack)

CAMPFIRE FIFTH WHEEL LIVING ROOM FEATURES

- Sound bar entertainment system with Bluetooth technology, USB ports
- 32" HD LED TV
- Cable TV hook-up with antenna and signal booster
- Under booth dinette storage
- Satellite prep with RG-6 cable
- High grade carpeting
- Residential fabric-covered valance w/removable drapes
- Tri-fold sleeper sofa w/storage

CAMPING MADE EASY PACKAGE: CAMPFIRE FIFTH WHEELS

- 30" friction hinge entry door
- E-Z Lube axles
- XL entry door grab handle
- Tough Guard painted skirt metal
- 4" extra long rain spouts
- Black tank flush system
- Outside TV hookup with 110 recep, and cable prep in pass thru
- Aluminum steps
- Interior access, manual override for the slide rooms
- Illuminated light switch
- 22" deep drawers
- Dual battery tray w/battery disconnect
- Solar prep
- LED interior lighting

OPTIONS: CAMPFIRE FIFTH WHEELS

- Free-standing residential dinette with four chairs
- Upgraded 15,000 BTU AC
- 50 AMP electrical service w/detachable cord, and 2nd AC prep (26FWRL)
- 2nd 13.5 A/C (Except 26FWRL)